

PATIO DU CAFÉ

CEtte PARTIE DU JARDIN ZOOLOGIQUE
ILLUSTRE LA FABLE D'ALPHONSE DAUDET
"LA CHEVRE DE M. SÉGUIN".
LE RUISSEAU ET L'ÉTANG À POISSON
SÉPARENT LES ENFANTS DES ANIMAUX.
DU HAUT DE LA MONTAGNE UN
LOUD GUETTE LA PETITE CHEVRE.

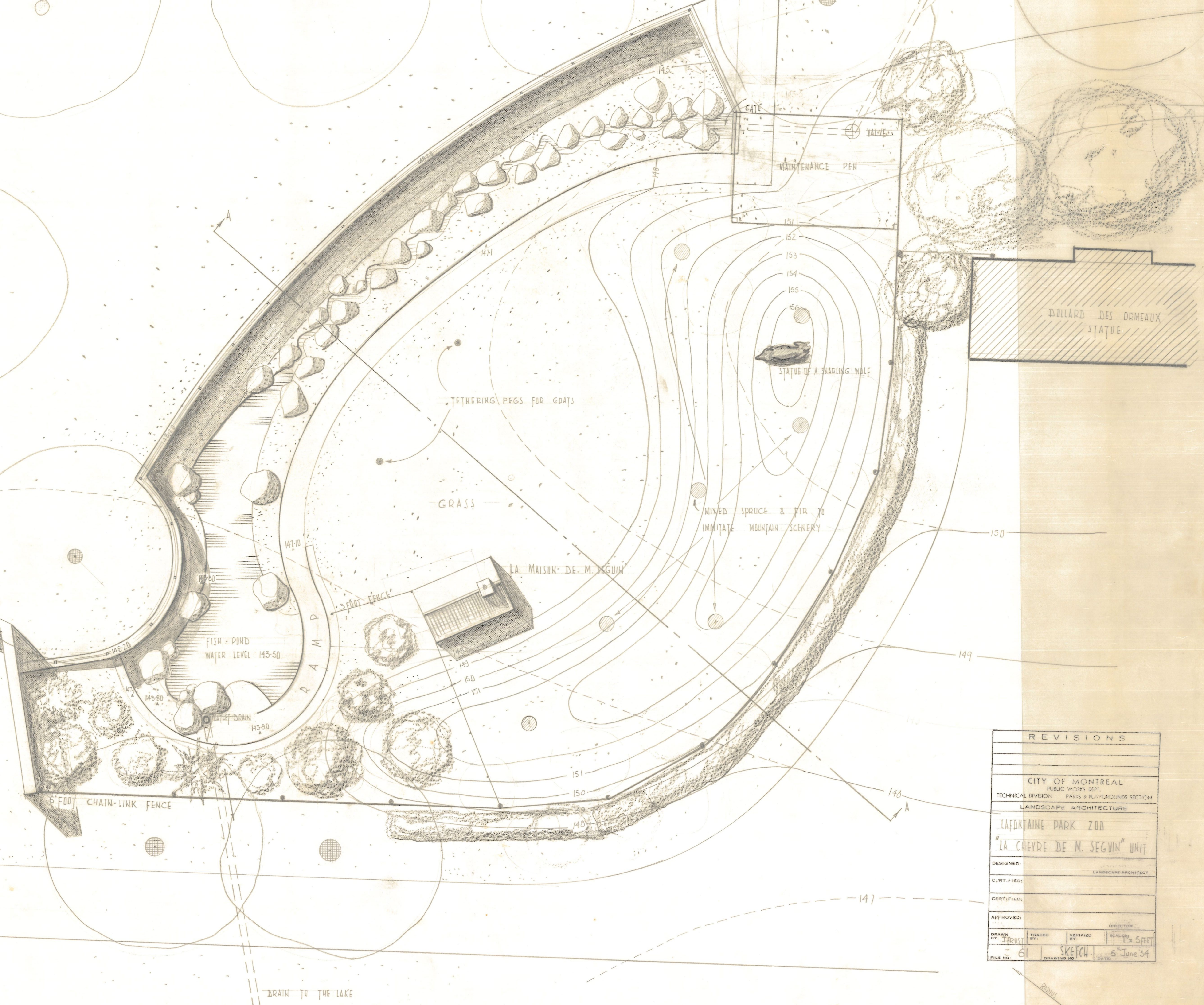

REVISIONS			
CITY OF MONTREAL PUBLIC WORKS DEPT. TECHNICAL DIVISION PARS & PLAYGROUNDS SECTION LANDSCAPE ARCHITECTURE			
LAFONTAINE PARK ZOO "LA CHEVRE DE M. SÉGUIN" UNIT			
DESIGNED:	LANDSCAPE ARCHITECT		
CRT. FIED:			
CERTIFIED:			
APPROVED:			
DRAWN BY: J. ROSE	TRACED BY:	VERIFIED BY:	DRAWN AT: 1/8" = 1' SHEET
FILE NO: 61	DRAWING NO: SKETCH	DATE: 6 June '54	