

MAP OF THE CITY OF MONTREAL

INCLUDING CITIES OF WESTMOUNT, OUTREMONT, VERDUN, MAISONNEUVE AND MOUNT-ROYAL.

Prepared Expressly for
LOVELL MONTREAL DIRECTORY
For 1913-1914

COPYRIGHT, CANADA 1913
By CHAS E. GOAD & CO
CIVIL ENGINEERS

MONTREAL, TORONTO, WINNIPEG
VANCOUVER, CANADA
LONDON, ENGLAND.

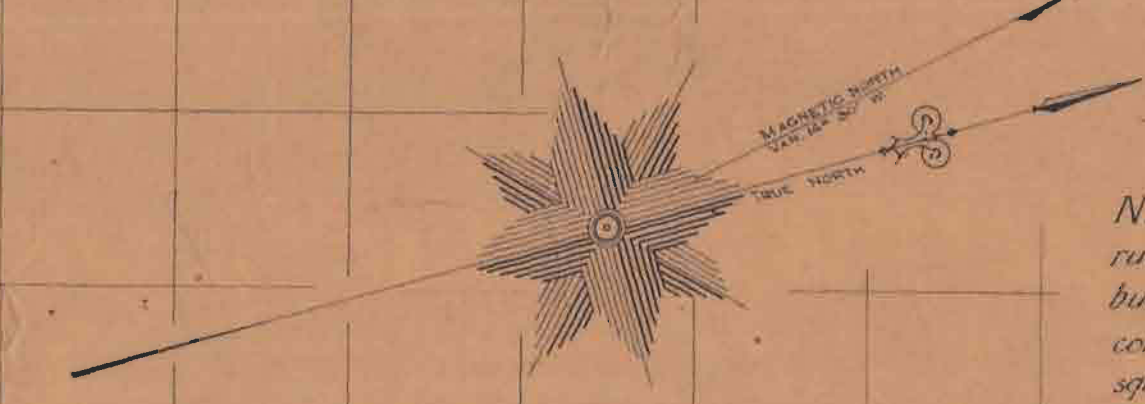

STREET INDEX
N.B. The Map is divided into quarter mile squares by lines running North & South and East & West. To locate a street or public building, note the letter and number against it on this map, then find the corresponding letter and number in margin of Map and follow the square horizontally & vertically from them. The required name will be found in the square indicated. One block is 1/4 mile, but will be found in the square horizontally opposite 1/4 and vertically in line with 19.

INDEX TO STREETS

A	Abbeville St.	Abbeville St.	Abbeville St.
B	Abbeville St.	Abbeville St.	Abbeville St.
C	Abbeville St.	Abbeville St.	Abbeville St.
D	Abbeville St.	Abbeville St.	Abbeville St.
E	Abbeville St.	Abbeville St.	Abbeville St.
F	Abbeville St.	Abbeville St.	Abbeville St.
G	Abbeville St.	Abbeville St.	Abbeville St.
H	Abbeville St.	Abbeville St.	Abbeville St.
I	Abbeville St.	Abbeville St.	Abbeville St.
J	Abbeville St.	Abbeville St.	Abbeville St.
K	Abbeville St.	Abbeville St.	Abbeville St.
L	Abbeville St.	Abbeville St.	Abbeville St.
M	Abbeville St.	Abbeville St.	Abbeville St.
N	Abbeville St.	Abbeville St.	Abbeville St.
O	Abbeville St.	Abbeville St.	Abbeville St.
P	Abbeville St.	Abbeville St.	Abbeville St.
Q	Abbeville St.	Abbeville St.	Abbeville St.
R	Abbeville St.	Abbeville St.	Abbeville St.
S	Abbeville St.	Abbeville St.	Abbeville St.
T	Abbeville St.	Abbeville St.	Abbeville St.
U	Abbeville St.	Abbeville St.	Abbeville St.
V	Abbeville St.	Abbeville St.	Abbeville St.
W	Abbeville St.	Abbeville St.	Abbeville St.
X	Abbeville St.	Abbeville St.	Abbeville St.
Y	Abbeville St.	Abbeville St.	Abbeville St.
Z	Abbeville St.	Abbeville St.	Abbeville St.

1913-14

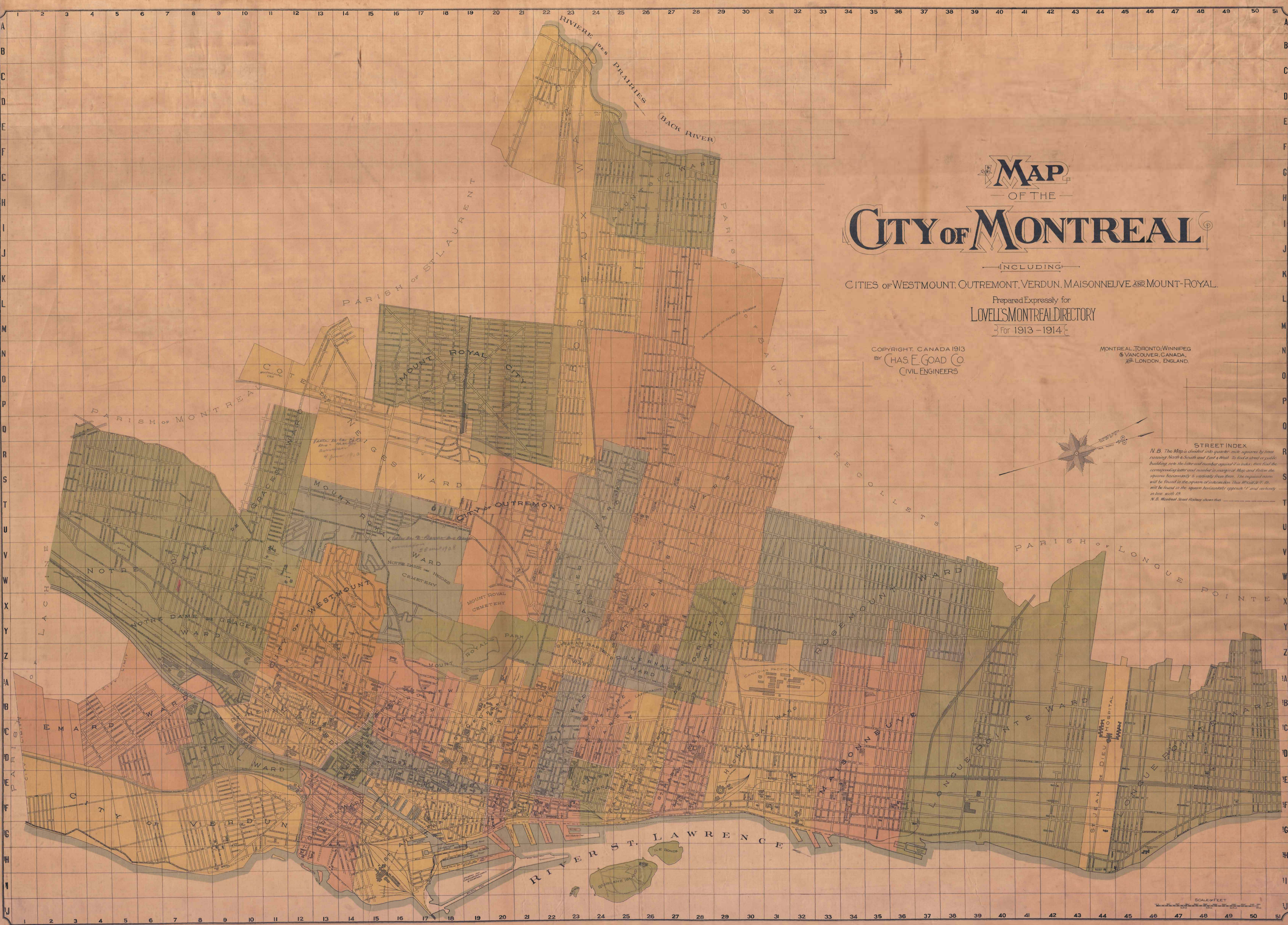

MAP
OF THE
CITY OF MONTREAL

INCLUDING
CITIES OF WESTMOUNT, OUTREMONT, VERDUN, MAISONNEUVE AND MOUNT-ROYAL.
Prepared Expressly for
LOVELL'S MONTREAL DIRECTORY
For 1913-1914

COPYRIGHT, CANADA 1913
BY CHAS. E. GOAD CO.
CIVIL ENGINEERS

MONTREAL, TORONTO, WINNIPEG
& VANCOUVER, CANADA,
& LONDON, ENGLAND.

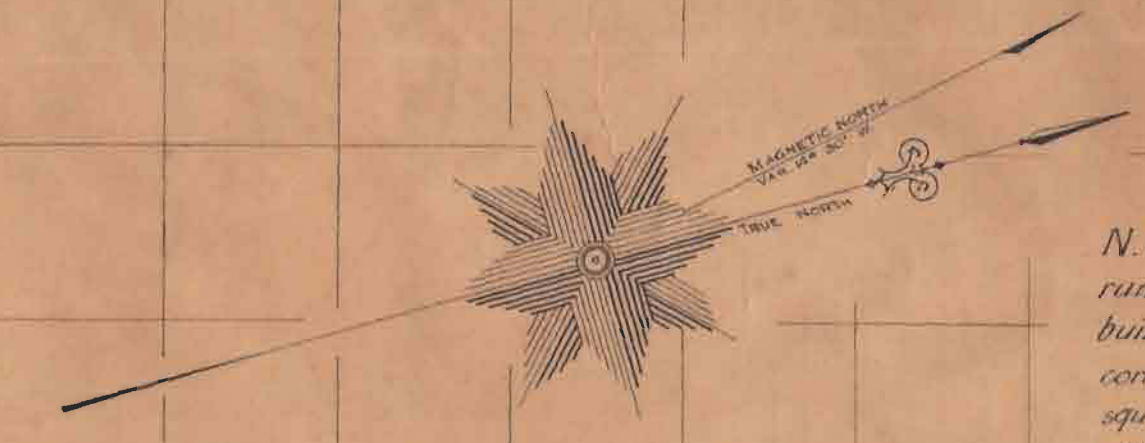

STREET INDEX
N.B. The Map is divided into quarters, each quarter by itself retaining North & South and East & West. To find a street in public buildings, note the letter and number against it in Index. Then find the corresponding letter and number in reverse of Map and follow the square accordingly & it is readily found. The original drawing will be found in the square of intersection. Thus Mount St. H. will be found in the square between 17 and 18 and 17 and 18.

INDEX TO STREETS

A	B	C	D	E	F	G	H	I	J	K	L	M	N	O	P	Q	R	S	T	U	V	W	X	Y	Z	1A	1B	1C	1D	1E	1F	1G	1H	1I	1J	1K	1L	1M	1N	1O	1P	1Q	1R	1S	1T	1U	1V	1W	1X	1Y	1Z
1	2	3	4	5	6	7	8	9	10	11	12	13	14	15	16	17	18	19	20	21	22	23	24	25	26	27	28	29	30	31	32	33	34	35	36	37	38	39	40	41	42	43	44	45	46	47	48	49	50	51	