

Contour Plan in the vicinity of the Redpath Property.

Showing
Proposed Boulevard from Mountain Street to Pine Avenue,
and
Proposed lay out of the Redpath Property

Sewerage Office, Montreal Dec 14th 1910

*John A. ...
City Surveyor
Montreal*

*Stuart Howard
Deputy City Surveyor*

Scale: 50 feet to an inch

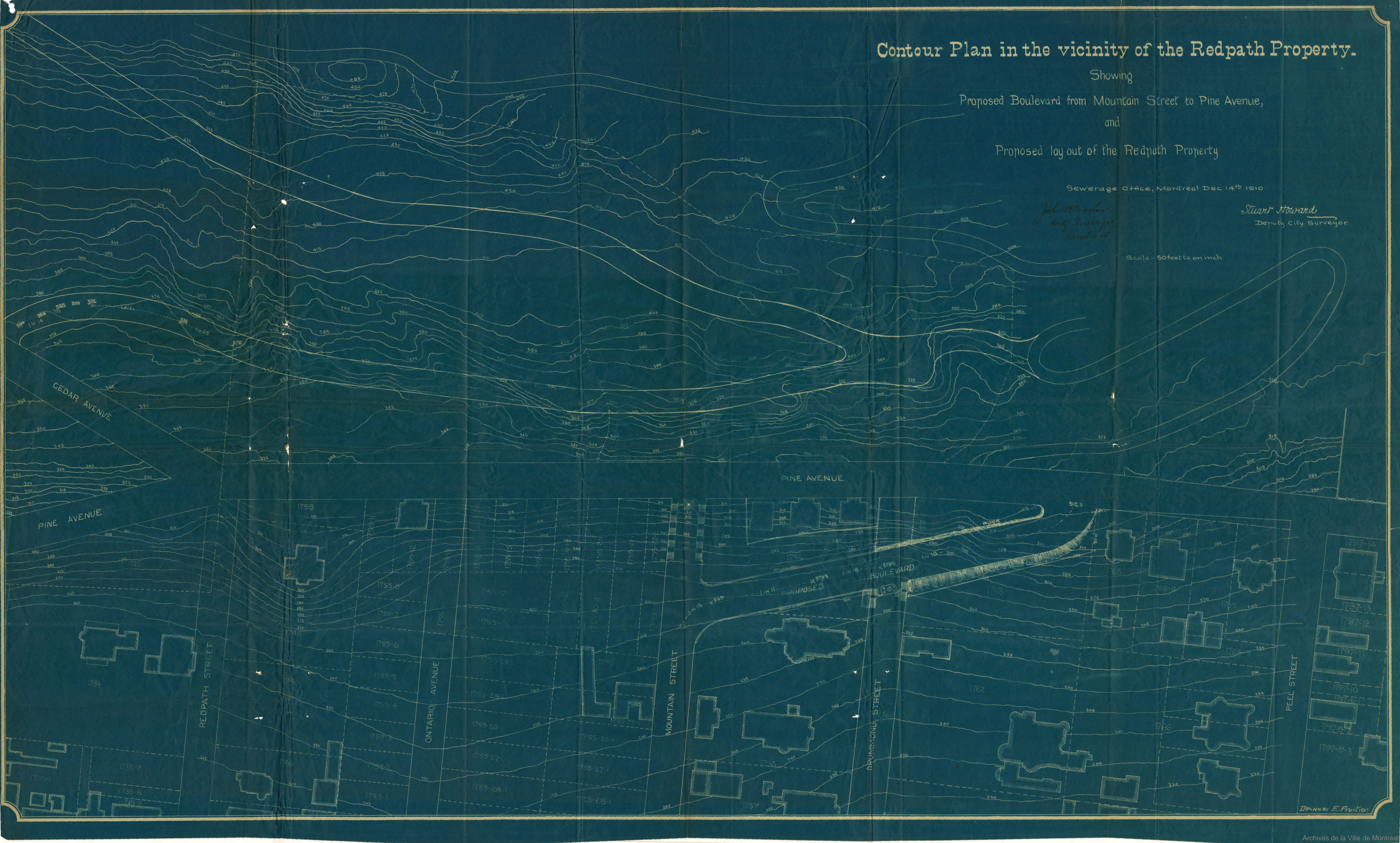

DRAWN BY E. Fruitier