

GP2593

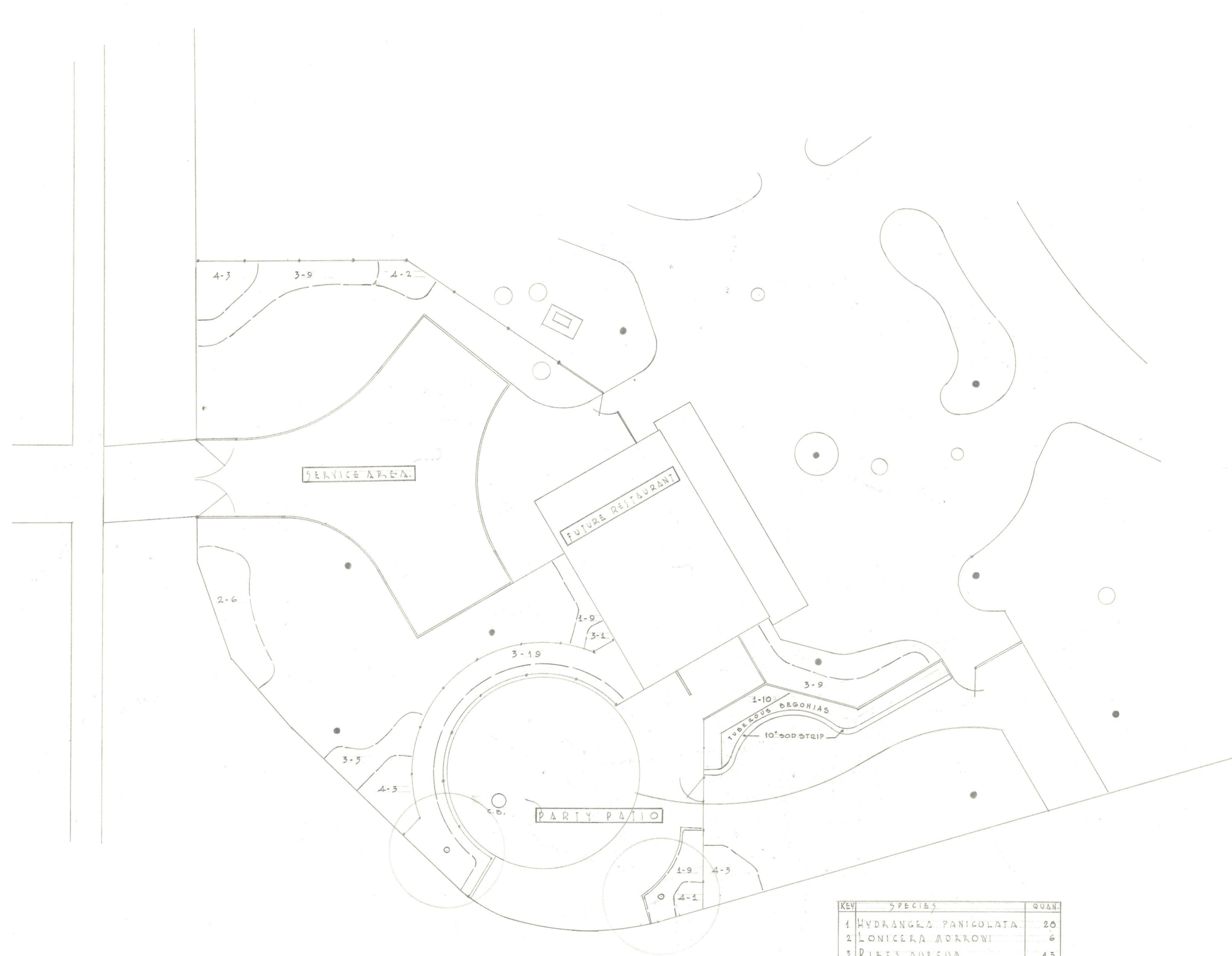

KEY	SPECIES	QUAN.
1	HYDRANGEA PANICOLATA	20
2	LONICEEA MORROWI	6
3	RIBES AUREUM	45
4	VIBURNUM LANTANA	12
5	ACER SACCHARUM	2

NOTE: 1<sup>ST</sup> FIGURE DENOTES KEY. THUS 4-1  
 = VIBURNUM LANTANA.  
 ● EXISTING TREES.  
 ○ PROPOSED TREES.

CITY OF MONTREAL  
 PUBLIC WORKS DEPARTMENT  
 TECHNICAL DIVISION "Section of Construction"  
 LANDSCAPE ARCHITECTURE

LA FONTAINE PARK  
 CHILDREN ZOO-RESTAURANT AREA  
 PLANTING PLAN

DESIGNED BY: *W. G. ...*

CERTIFIED BY: *Ormy ...*

APPROVED BY: *Ormy ...*

DATE: \_\_\_\_\_

DRAWN BY: \_\_\_\_\_ DATE: \_\_\_\_\_ SCALE: 1" = 30'-0"

INDEX NO. 61-E DRWG. NO. 1004P SHEET: \_\_\_\_\_ OF: \_\_\_\_\_