

SHRUBS

|    |                                   |    |
|----|-----------------------------------|----|
| 1  | AMELANCHIER CANADENSIS            | 3  |
| 2  | BERBERIS THUNBERGI ATROPURPUREA   | 8  |
| 3  | CARAGANA PYCMAEA                  | 16 |
| 4  | CORNUS ALBA SIBIRICA              | 4  |
| 5  | COTONEASTER ACUTIFOLIA            | 9  |
| 6  | COTONEASTER BULLATA               | 18 |
| 7  | FORSYTHIA OVATA                   | 8  |
| 8  | LONICERA TATARICA                 | 27 |
| 9  | PHILADELPHUS CORONARIUS AUREUS    | 10 |
| 10 | PHYSOCARPUS OPULIFOLIUS AUREA     | 50 |
| 11 | POTENTILLA FRUTICOSA - GOLD DROP- | 88 |
| 12 | ROSA RUGOSA F.J. GROOTENDORST     | 28 |
| 13 | SPIRAEA ARGUTA                    | 14 |
| 14 | SPIRAEA ARGUTA ANTHONY WATERER    | 53 |
| 15 | SPIRAEA VAN HOUTTEI               | 33 |
| 16 | SYMPHORICARPOS ORBICULATUS        | 28 |
| 17 | WEIGELA WAGNERI BRISTOL RUBY      | 15 |
| 18 | VIBURNUM OPULUS NANUM             | 12 |

PLANT LIST

TREES

|   |                     |   |
|---|---------------------|---|
| A | CRATAEGUS CRUSGALLI | 3 |
| B | BETULA PENDULA      | 9 |
| C | DICEA PUNGENS       | 6 |
| D | THUJA OCCIDENTALIS  | 4 |

PERENNIALS

|    |              |    |
|----|--------------|----|
| 50 | HEMEROCALLIS | 43 |
|----|--------------|----|

VIAU ST.

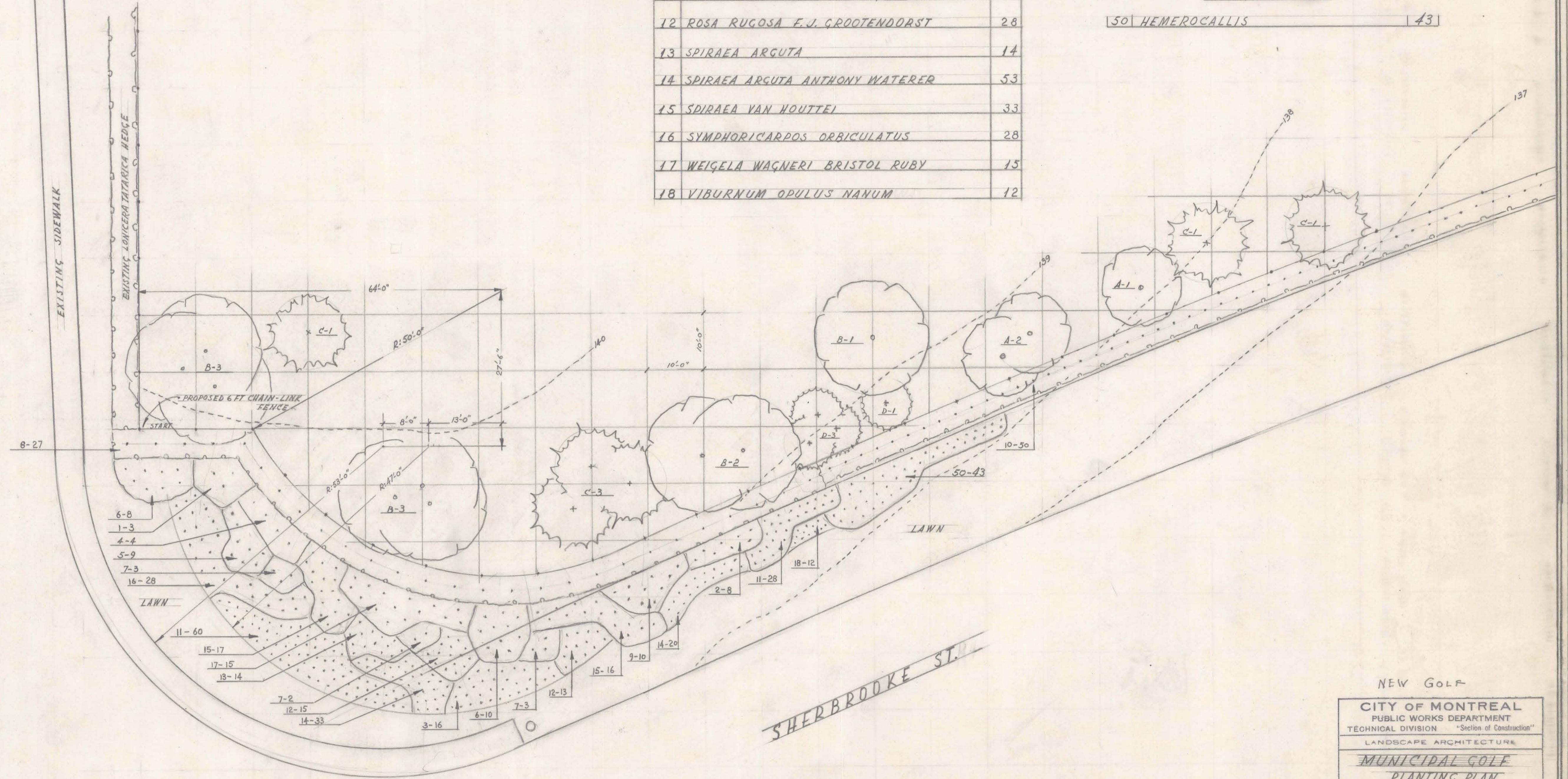

NEW GOLF

CITY OF MONTREAL  
PUBLIC WORKS DEPARTMENT  
TECHNICAL DIVISION "Section of Construction"

LANDSCAPE ARCHITECTURE

**MUNICIPAL GOLF**  
**PLANTING PLAN**  
NORTH-EAST CORNER OF  
SHERBROOKE & VIAU STREETS

DESIGNED BY: *Warner & Sons*  
LANDSCAPE ARCHITECT

CERTIFIED BY: *Don Douglas*  
TECHNICAL SECTION ENGINEER

APPROVED BY: *M.C. BOILLARD*  
DIRECTOR OF PARKS

DATE: 20-3-57

APPROVED BY: *R. Miller*  
SUPERVISOR OF PUBLIC WORKS

DATE: \_\_\_\_\_

DRAWN BY: \_\_\_\_\_ DATE: \_\_\_\_\_ SCALE: \_\_\_\_\_

INDEX NO. 85-N DRWG. NO. 1004-C SHEET \_\_\_\_\_ OF \_\_\_\_\_